

Installation guide K 1151"VOCO"

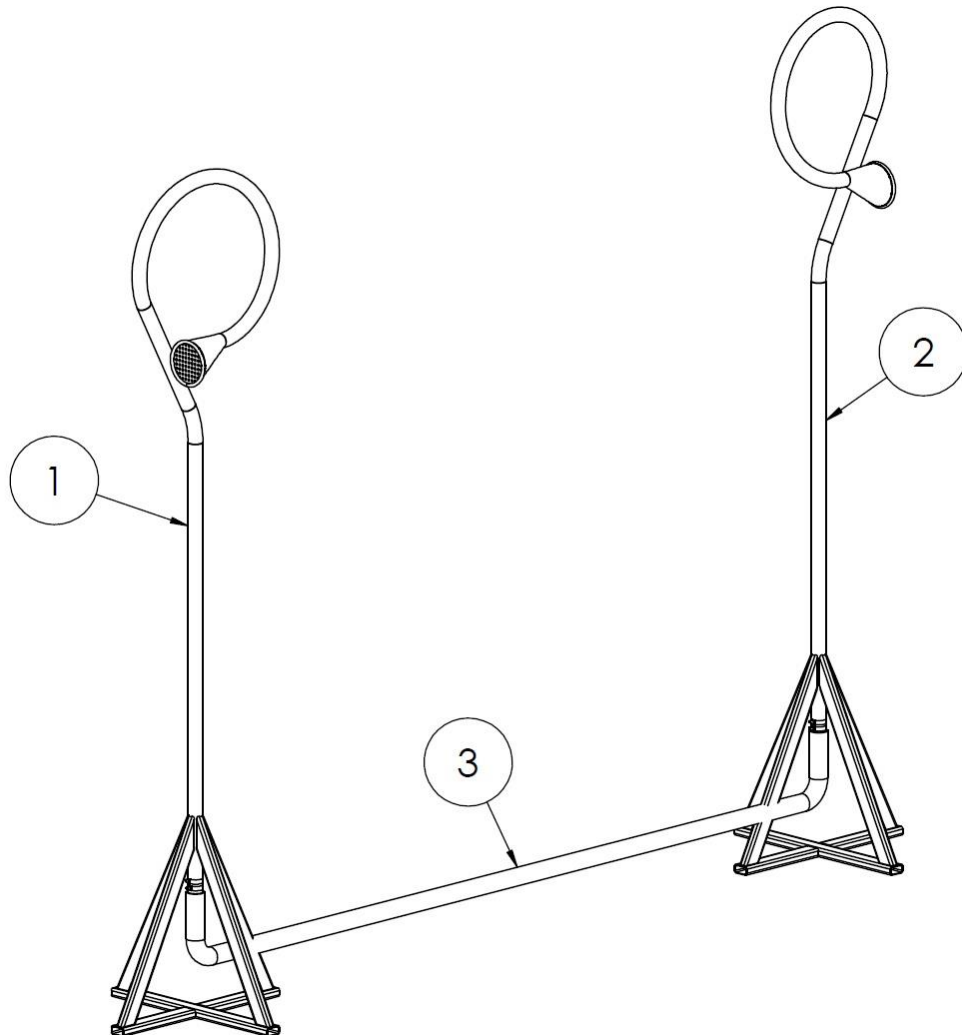

List of parts for installation:

Part	Part's number	Quantity
1	Telephone pipe 1	1
2	Telephone pipe 2	1
3	Connecting pipe	1

Marking of foundation depth:

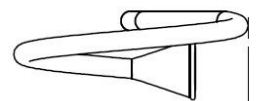
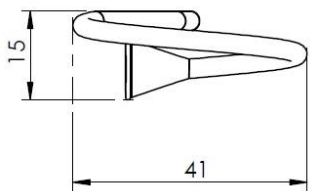
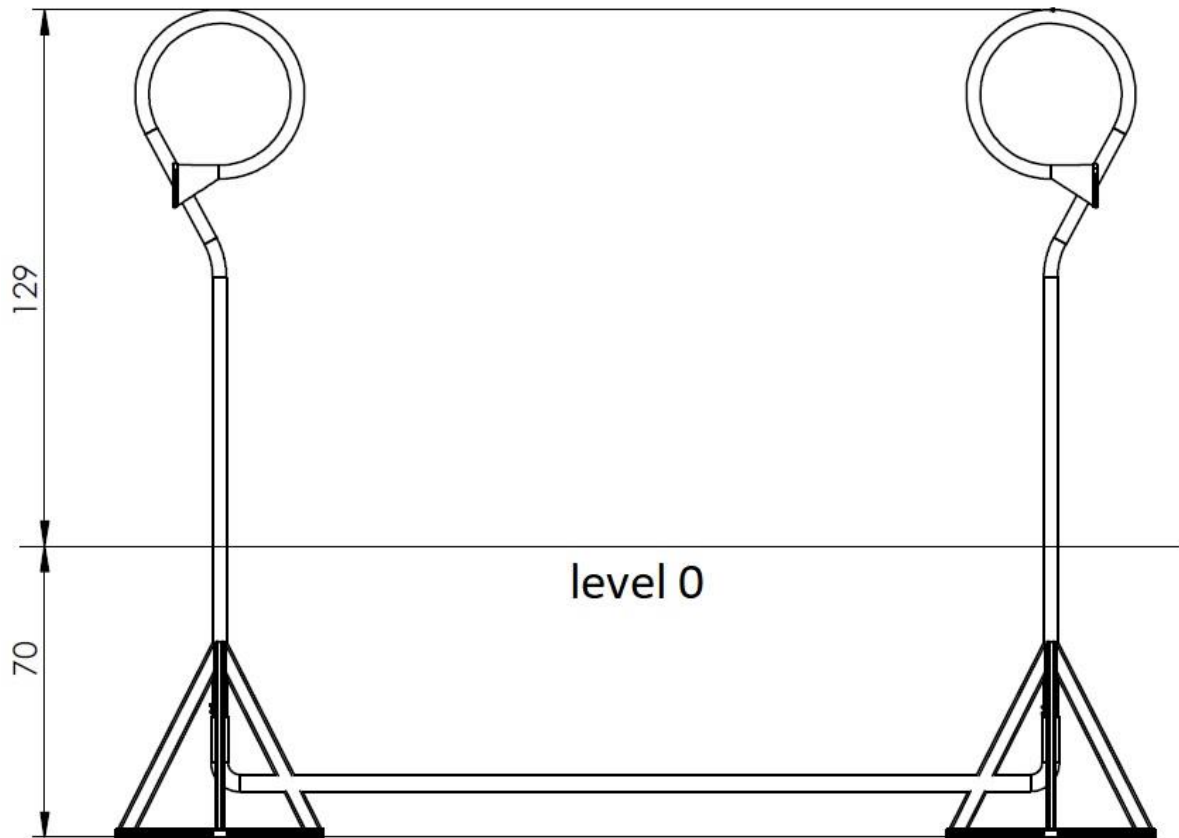

Max 1000

ASSEMBLY NOTES

Order of installation:

1. Marking the installation holes.
2. Embed the telephone pipes into the installation holes.
3. Installation of connecting pipe.
4. Fill the holes above the concrete.

Location of installation hole (foundation blocks):

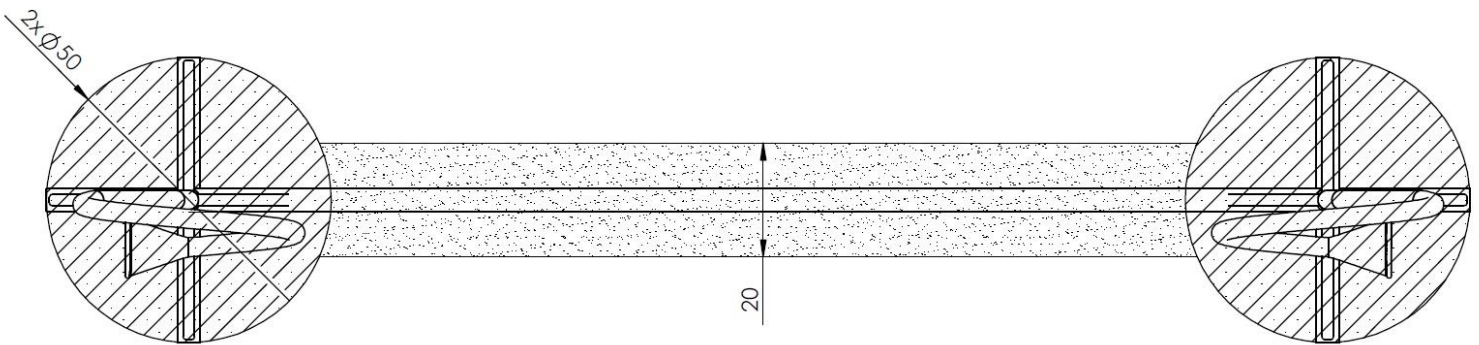

Comment:

The height of block foundations – 30 cm (for the elements which are anchoring 70 cm into the ground).